



# *Drive into Style* WITH HPM'S **PREMIUM GARAGE & CARPORT PLANS**

## Where Design Meets Everyday Practicality

Discover a new level of modern solutions for your home with HPM Homes' latest garage and carport plans, available statewide. With three garage plans and one carport plan to choose from, explore these innovative designs to upgrade your property's aesthetic and functionality seamlessly.

### Garage #528

- 528 square feet total area
- Storage area

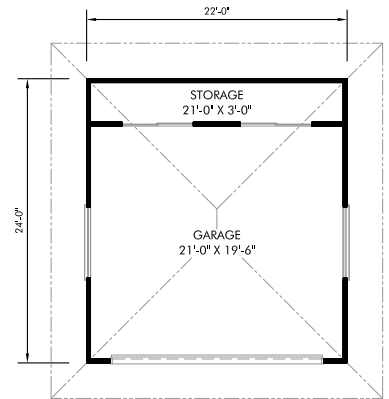

### Garage #576

- 576 square feet total area
- Side entrance door

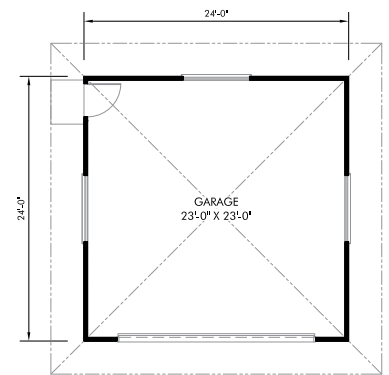

### Garage #672

- 672 square feet total area
- Side entrance door
- Storage area
- Full bath
- Garage door

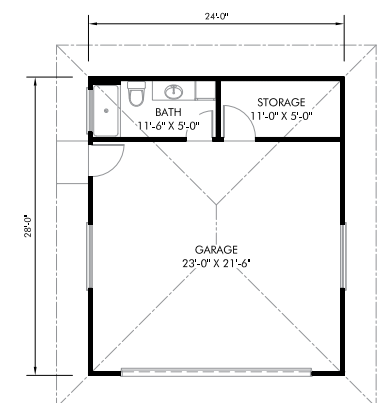

**Contact your nearest Home Planning Consultant today:**

**Hilo:** (808) 865-5820 | **Waimea & Kona:** (808) 865-5865 | **Kaua'i, Maui, O'ahu:** (808) 727-1039





# Covered Comfort

## SUN-PROOF YOUR SPACE WITH **HPM**

Enhance your property with HPM Homes' versatile carport plan. Stylish, cost-effective and durable, it shelters your vehicle and belongings while adding value to your property. Upgrade your outdoor space with a practical and aesthetically pleasing addition that seamlessly integrates into your lifestyle.

### Carport #784

- 784 square feet total area
- Storage area

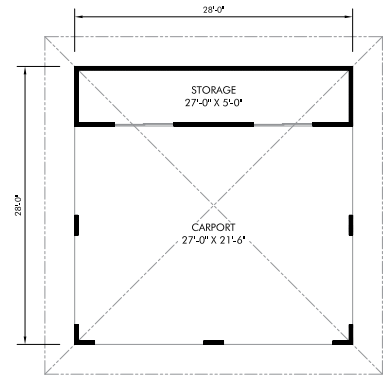

### Materials Package Starting at

# \$43,000

for Garage and Carport plans.

Pricing varies by island, and some materials are not available on Kaua'i, O'ahu and Maui.

### *What's Included:*

- Foundation hardware
- Framing lumber
- Pre-manufactured trusses
- Corrugated metal roofing
- Drywall
- Plywood exterior siding
- Paint and primer
- Electrical fixtures
- Vinyl frame double pane low-e windows\*
- Fiberglass and pre-hung doors\*
- Finish plumbing\*

*What's Not Included:* Concrete, form boards, gutters, rough-in plumbing and electrical materials, garage door and opener (for applicable plans), and wastewater/water catchment systems are not part of our material package price. Labor is also not included, providing you with flexibility and control over your project.

**Contact your nearest Home Planning Consultant today:**

**Hilo:** (808) 865-5820 | **Waimea & Kona:** (808) 865-5865 | **Kaua'i, Maui, O'ahu:** (808) 727-1039

